

# Entrance, Bed, Desk and Stove Placement

## Room by Room Analysis

- The Entrance
- The Living Room
- The Bedroom
- The Office
- The Kitchen
- The Bathroom
- Doorways
- The Floor Plan

Copyright 2002, Feng Shui Designs, Inc. / ChinaStudies / Helen and James Jay

---

---

---

---

---

---

---

---

## The Entrance

- Uncluttered View of Entry



Copyright 2002, Feng Shui Designs, Inc. / ChinaStudies / Helen and James Jay

---

---

---

---

---

---

---

---

## The Entrance



Copyright 2002, Feng Shui Designs, Inc. / ChinaStudies / Helen and James Jay

---

---

---

---

---

---

---

---



# Entrance, Bed, Desk and Stove Placement

## Room of First Sight

- Bathroom
- Bedroom
- Kitchen
- Utility Room
- Living Room
- Library

Copyright 2002, Feng Shui Designs, Inc. / ChinaStudies / Helen and James Jay

---

---

---

---

---

---

---

---

## The Living Room

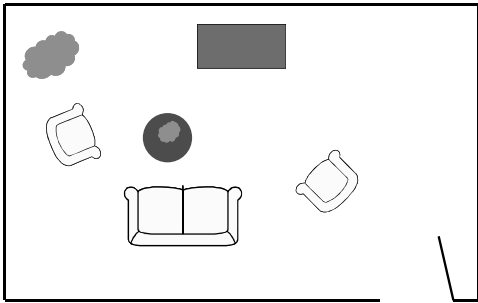

Copyright 2002, Feng Shui Designs, Inc. / ChinaStudies / Helen and James Jay

---

---

---

---

---

---

---

---

## The Living Room

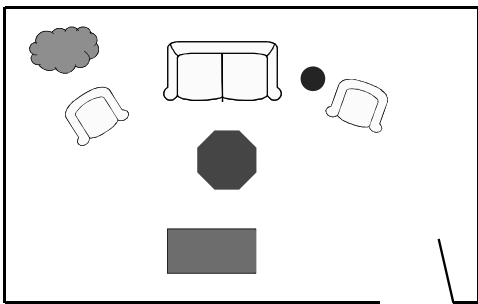

Copyright 2002, Feng Shui Designs, Inc. / ChinaStudies / Helen and James Jay

---

---

---

---

---

---

---

---



# Entrance, Bed, Desk and Stove Placement

## The Living Room

- Add Live Plants
  - Bring in Healthy Qi.



Copyright 2002, Feng Shui Designs, Inc. / ChinaStudies / Helen and James Jay

---

---

---

---

---

---

---

---

## The Living Room

- Bring Color Into Room.
  - Add Paint or display objects with earth tones.
  - Yellow, gold and lighter shades of brown

Copyright 2002, Feng Shui Designs, Inc. / ChinaStudies / Helen and James Jay

---

---

---

---

---

---

---

---

## The Bedroom

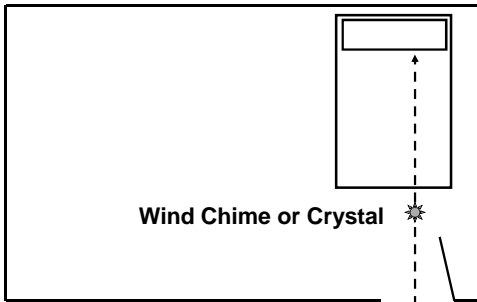

Copyright 2002, Feng Shui Designs, Inc. / ChinaStudies / Helen and James Jay

---

---

---

---

---

---

---

---



Entrance, Bed, Desk and Stove Placement

The Bedroom



Copyright 2002, Feng Shui Designs, Inc. / ChinaStudies / Helen and James Jay

---

---

---

---

---

---

---

---

The Bedroom



Copyright 2002, Feng Shui Designs, Inc. / ChinaStudies / Helen and James Jay

---

---

---

---

---

---

---

---

The Bedroom



Copyright 2002, Feng Shui Designs, Inc. / ChinaStudies / Helen and James Jay

---

---

---

---

---

---

---

---



# Entrance, Bed, Desk and Stove Placement



---

---

---

---

---

---

---

---

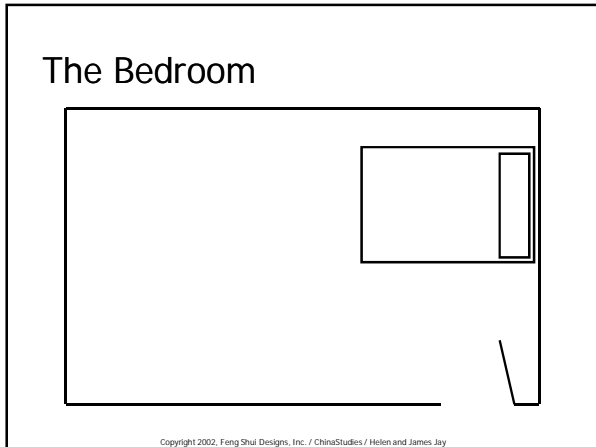

---

---

---

---

---

---

---

---

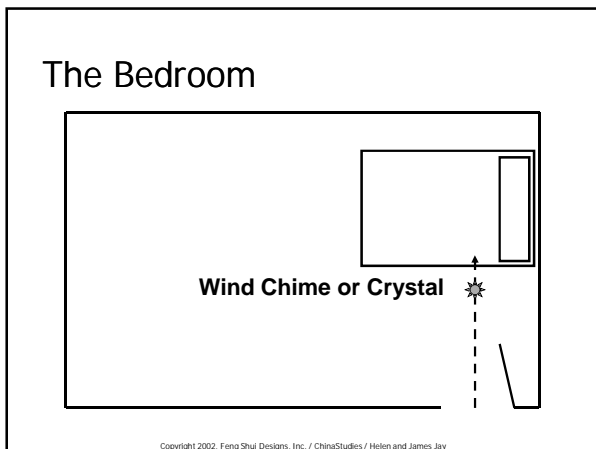

---

---

---

---

---

---

---

---



Entrance, Bed, Desk and Stove Placement

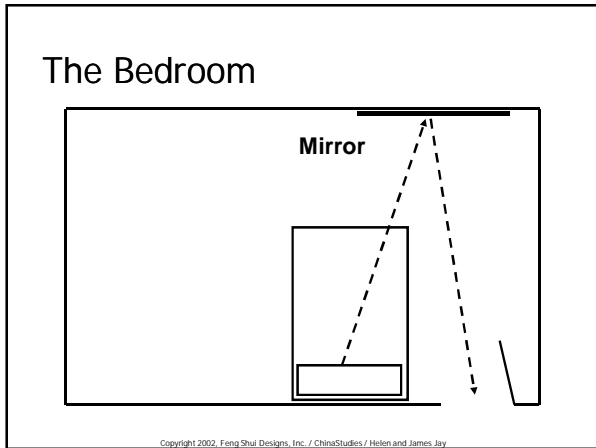

---

---

---

---

---

---

---

---

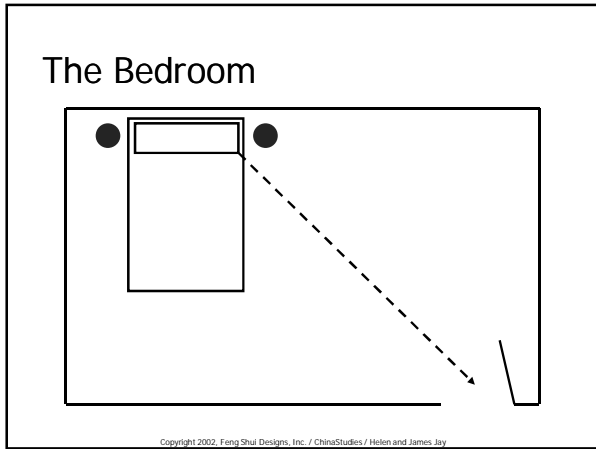

---

---

---

---

---

---

---

---

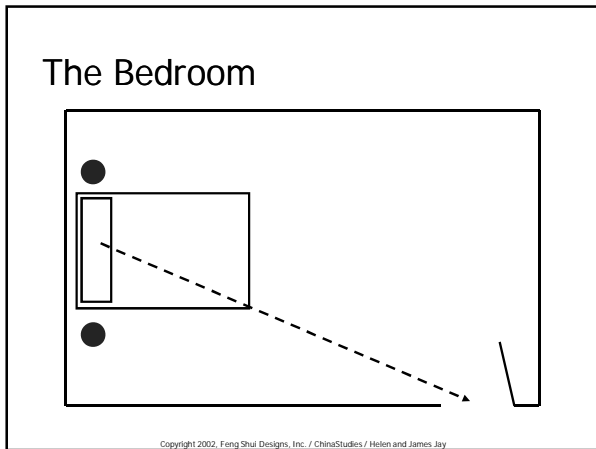

---

---

---

---

---

---

---

---



# Entrance, Bed, Desk and Stove Placement

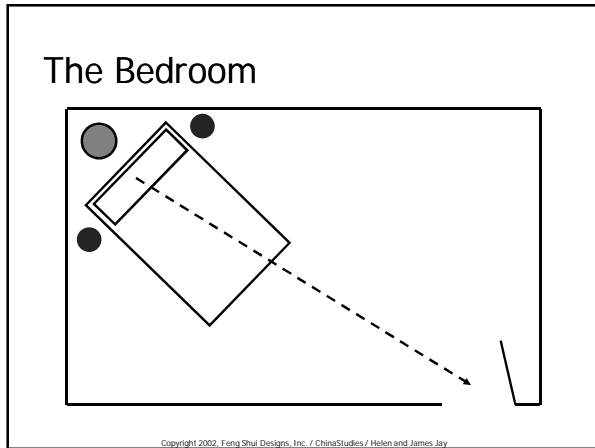

---

---

---

---

---

---

---

---

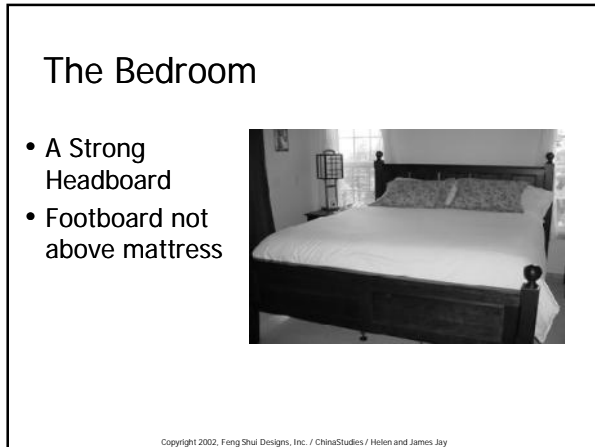

---

---

---

---

---

---

---

---

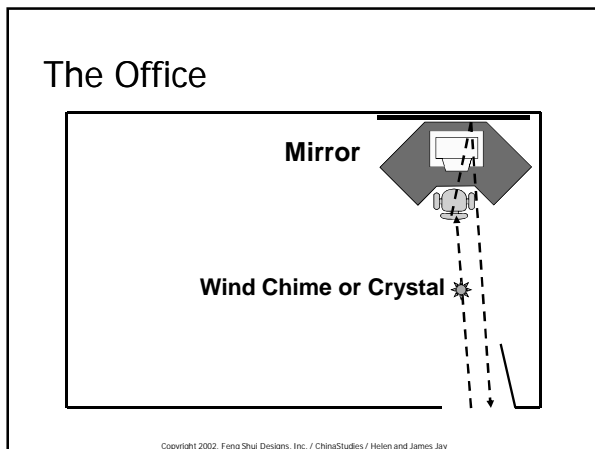

---

---

---

---

---

---

---

---



Entrance, Bed, Desk and Stove Placement

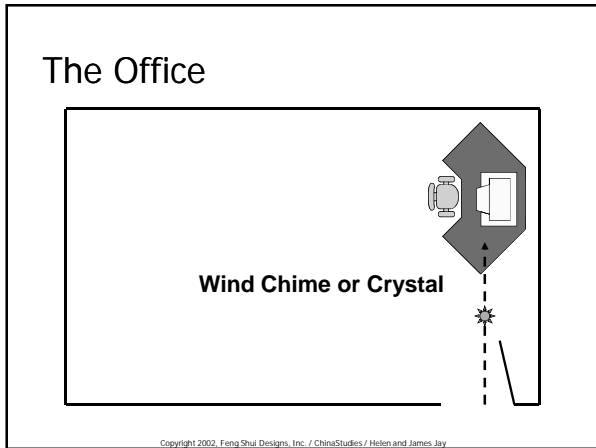

---

---

---

---

---

---

---

---

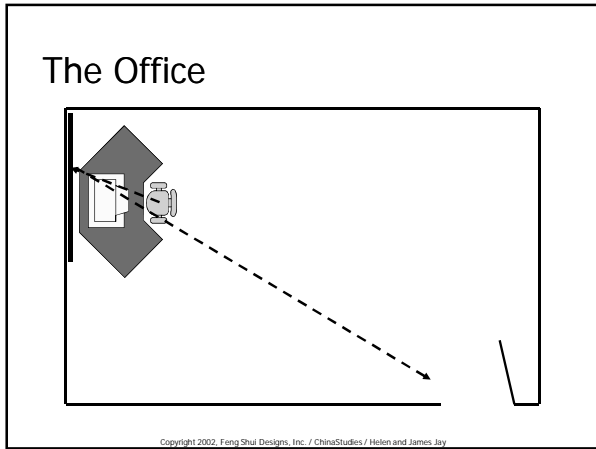

---

---

---

---

---

---

---

---

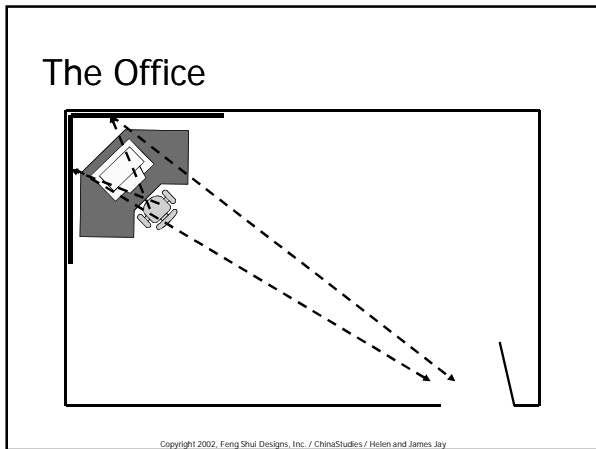

---

---

---

---

---

---

---

---





# Entrance, Bed, Desk and Stove Placement

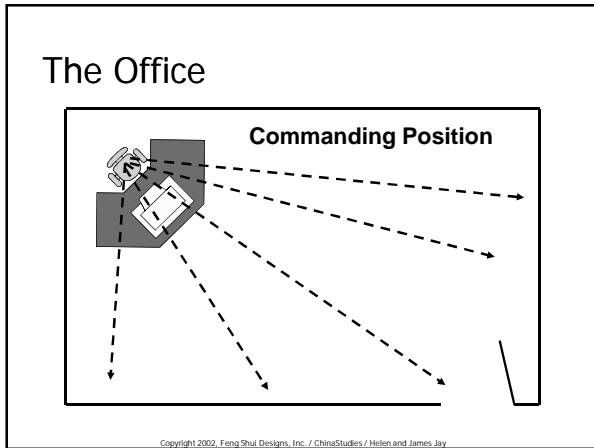

---

---

---

---

---

---

---

---

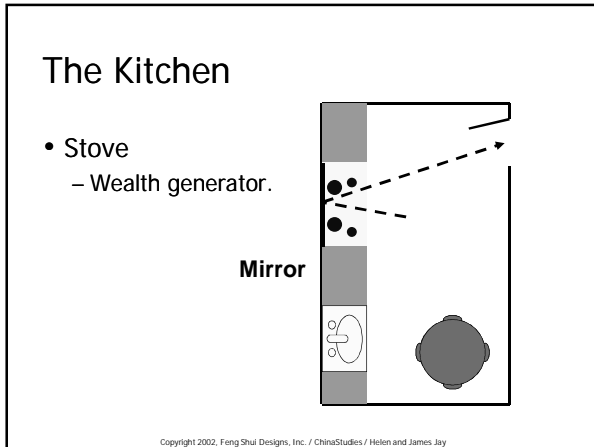

---

---

---

---

---

---

---

---



---

---

---

---

---

---

---

---



# Entrance, Bed, Desk and Stove Placement

## The Kitchen

- Sink Adjacent to Stove
  - Fire and water conflict.

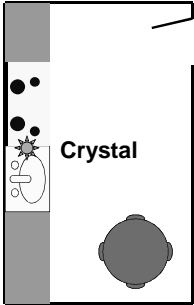

Copyright 2002, Feng Shui Designs, Inc. / ChinaStudies / Helen and James Jay

---

---

---

---

---

---

---

---

## The Kitchen

- Appliances
  - Should be in good repair.



Copyright 2002, Feng Shui Designs, Inc. / ChinaStudies / Helen and James Jay

---

---

---

---

---

---

---

---

## The Bedroom/Bathroom

- The Master Suite
  - No door to bath.

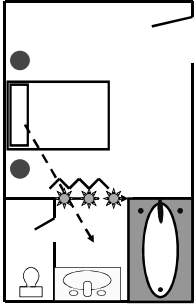

Copyright 2002, Feng Shui Designs, Inc. / ChinaStudies / Helen and James Jay

---

---

---

---

---

---

---

---



# Entrance, Bed, Desk and Stove Placement

## The Bedroom/Bathroom

- The Master Suite
  - No door to bath.



Copyright 2002, Feng Shui Designs, Inc. / ChinaStudies / Helen and James Jay

---

---

---

---

---

---

---

---

## The Bedroom/Bathroom

- The Master Suite
  - No door to bath.



Copyright 2002, Feng Shui Designs, Inc. / ChinaStudies / Helen and James Jay

---

---

---

---

---

---

---

---

## The Bedroom/Bathroom

- Protect Head of Bed

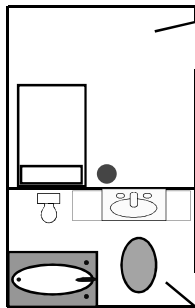

Copyright 2002, Feng Shui Designs, Inc. / ChinaStudies / Helen and James Jay

---

---

---

---

---

---

---

---



# Entrance, Bed, Desk and Stove Placement

## The Bedroom/Bathroom

- Protect Head of Bed

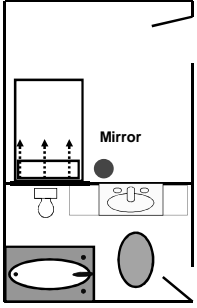

Copyright 2002, Feng Shui Designs, Inc. / ChinaStudies / Helen and James Jay

---

---

---

---

---

---

---

---

## The Bathroom

- Mirror Door to Hold Qi



Copyright 2002, Feng Shui Designs, Inc. / ChinaStudies / Helen and James Jay

---

---

---

---

---

---

---

---

## The Bathroom

- Interior Bathroom with no Outside Wall.



Copyright 2002, Feng Shui Designs, Inc. / ChinaStudies / Helen and James Jay

---

---

---

---

---

---

---

---



# Entrance, Bed, Desk and Stove Placement

## The Bathroom

- Check Toilet Seat



Copyright 2002, Feng Shui Designs, Inc. / ChinaStudies / Helen and James Jay

---

---

---

---

---

---

---

---

## The Bathroom

- Closed Lid Keeps Qi From Draining



Copyright 2002, Feng Shui Designs, Inc. / ChinaStudies / Helen and James Jay

---

---

---

---

---

---

---

---

## Doorways

- "Pierced Heart"  
– 3 or more doorways in a row.

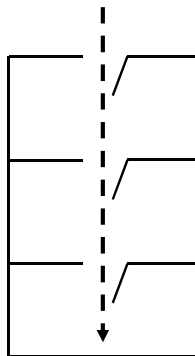

Copyright 2002, Feng Shui Designs, Inc. / ChinaStudies / Helen and James Jay

---

---

---

---

---

---

---

---



# Entrance, Bed, Desk and Stove Placement

## Doorways

- "Pierced Heart"
  - 3 or more doorways in a row.
  - Keep doors closed or hang flute inside above each door.

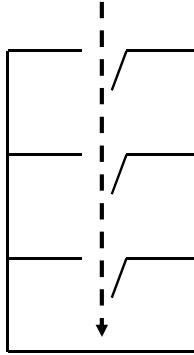

Copyright 2002, Feng Shui Designs, Inc. / ChinaStudies / Helen and James Jay

---

---

---

---

---

---

---

---

## Doorways

- 3 or More Doors Opening into a Tight Area

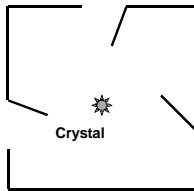

Copyright 2002, Feng Shui Designs, Inc. / ChinaStudies / Helen and James Jay

---

---

---

---

---

---

---

---

## Doorways

- "Bad Bite" Misaligned Doors

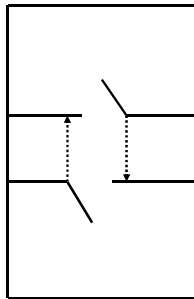

Copyright 2002, Feng Shui Designs, Inc. / ChinaStudies / Helen and James Jay

---

---

---

---

---

---

---

---



# Entrance, Bed, Desk and Stove Placement

## Doorways

- "Bad Bite"  
Misaligned Doors
  - Add mirrors or artwork.

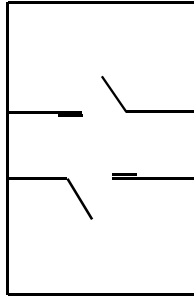

Copyright 2002, Feng Shui Designs, Inc. / ChinaStudies / Helen and James Jay

---

---

---

---

---

---

---

---

## Doorways

- "Battling Doors"
  - 2 doors hit when opened.
  - Cause arguing household.

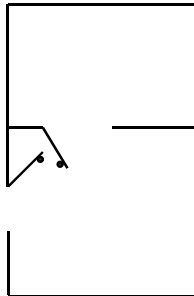

Copyright 2002, Feng Shui Designs, Inc. / ChinaStudies / Helen and James Jay

---

---

---

---

---

---

---

---

## Doorways

- Battling Door Solution
- Materials:
  - 18" length of new string or thin red ribbon.
- Procedure:
  - Sleep with red string or ribbon under your pillow for 9 days.
  - After 9 days, open doors until they almost touch.
  - Tie one end of string/ribbon to the stem of one door knob and the other end to the second door knob.
  - Use the Dispelling Mudra and chant Om Ma Ni Pad Me Hum nine times. Then cut the string/ribbon with a pair of scissors while visualizing all past, present or future potential or actual conflict (known or unknown) is removed and replaced by harmonious, pleasant and congenial energy.
  - Leave the ends of the string/ribbon dangling or wrap tightly around the door knob stem so as to not be visible.

Copyright 2002, Feng Shui Designs, Inc. / ChinaStudies / Helen and James Jay

---

---

---

---

---

---

---

---



# Entrance, Bed, Desk and Stove Placement

## Floor Plans

- Secure Rooms Behind Mid-line.
- Rooms Beyond the Front Door.
- Ba-Gua Considerations.

Copyright 2002, Feng Shui Designs, Inc. / ChinaStudies / Helen and James Jay

---

---

---

---

---

---

---

---

## Floor Plans

- Behind the Mid-line.

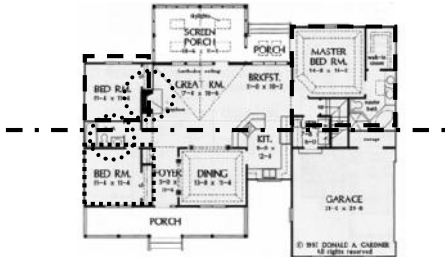

Copyright 2002, Feng Shui Designs, Inc. / ChinaStudies / Helen and James Jay

---

---

---

---

---

---

---

---

## Floor Plans

- Room Beyond Front Door.

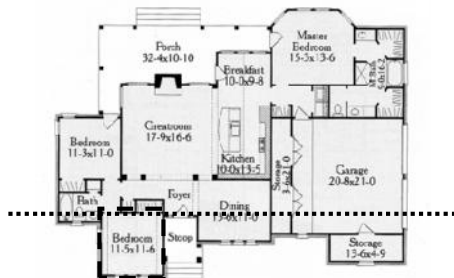

Copyright 2002, Feng Shui Designs, Inc. / ChinaStudies / Helen and James Jay

---

---

---

---

---

---

---

---

